

iBELL[®] b
Complete Home Solution



IBL VC 120YB VACUUM CLEANER

INSTRUCTION MANUAL

Read the manual carefully before using the product

1. Product Characteristics

- (1) Vacuum cleaner for wet and dry
- (2) Jacks on the base, easy for depositing accessories
- (3) Blowing function, satisfy different requirements

2. Structure and parts name

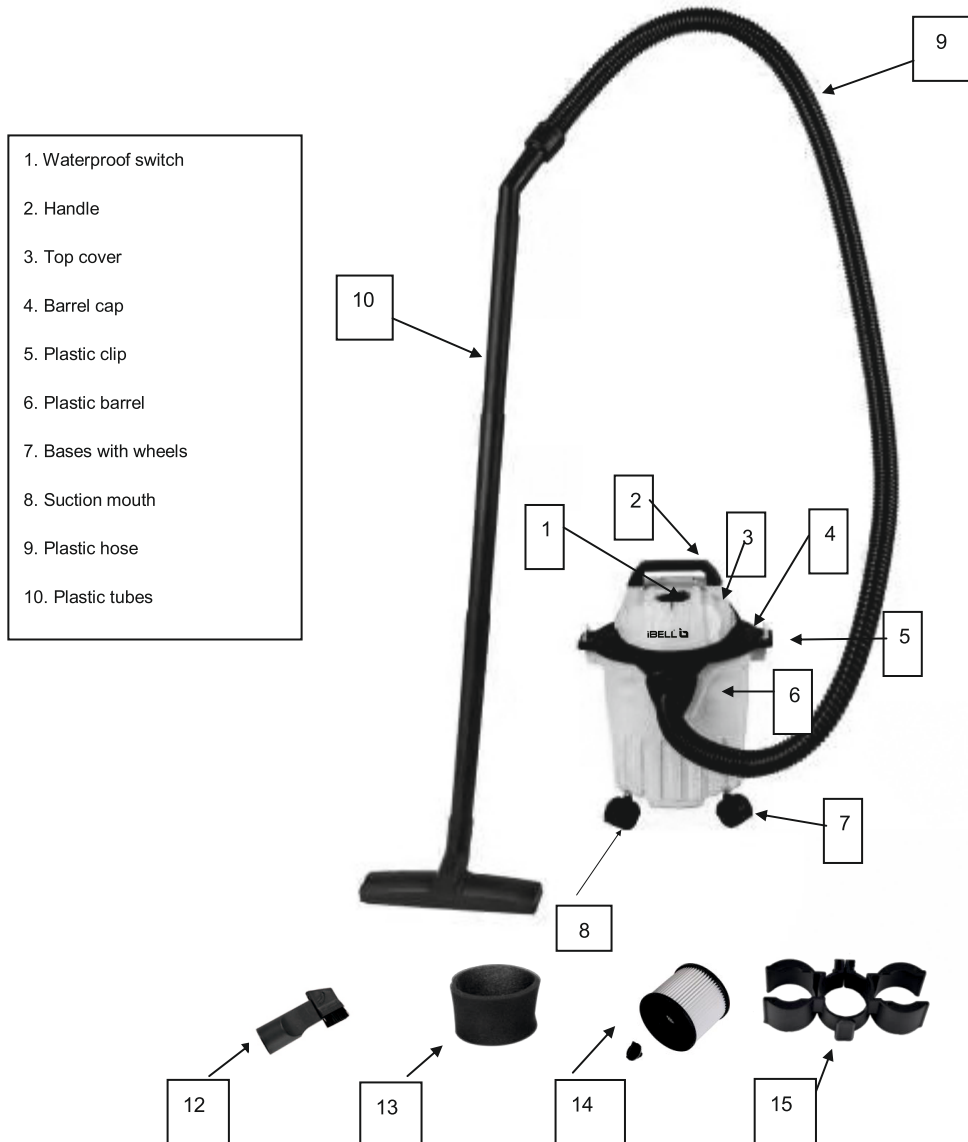

Use the right accessories according to different situations.

Brush for bookshelves, windows and bibulous brush for floor carpet, and tables, etc.

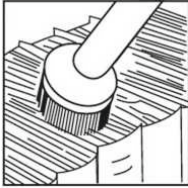

Crevice nozzle for crevice, corner, etc. Blowing mouth for blowing the dust away in the crevice of the machine

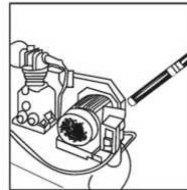
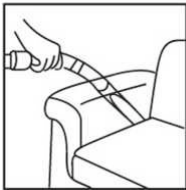

3. Safety Instruction

- (1) Check before operation that the local power supply is the same as the specification on the rating label.
- (2) Do not use machine in the combustible and explosive place in case the motor sparkcauses fire.

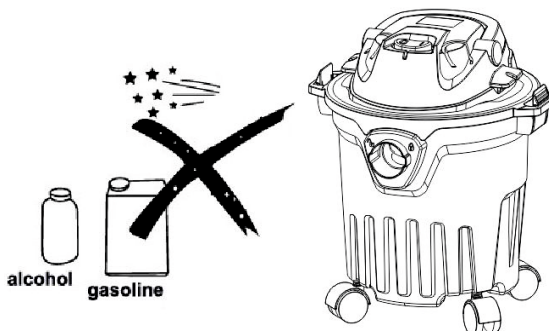

(3) Do not jam the air inlet, in case temperature rises and damage the motor.

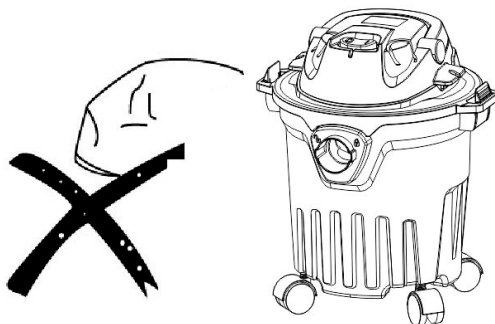

(4) Do not collect combustible and explosive objects such as burning cigarettes, gasoline, etc.

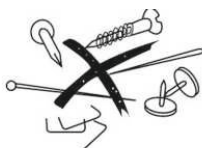

*Do not collect sharp objects.

*Do not collect objects which can easily stick to the filter such as calcareousness powder, gesso and graphite powder. Because they will block the ventilation and damage motor.

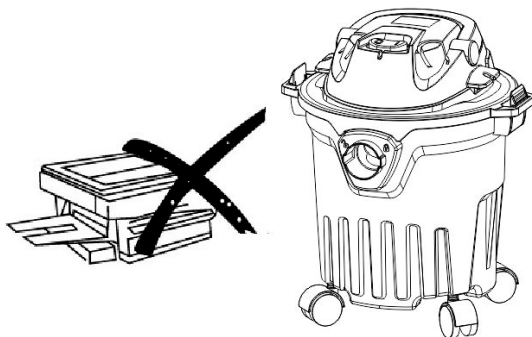

(5) Do not overturn the machine in case water goes into the motor and damages it

(6) Warning: do not overturn the machine in case water goes into the motor and causes damage. Do not use this machine as pump in case of motor burn.

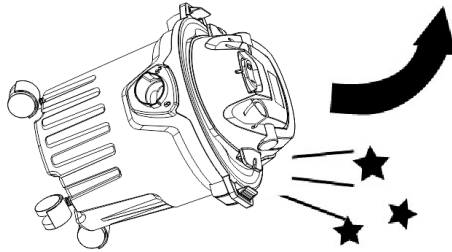

(7) Turn off the machine and remove the plug each time after use or under repairment.

(8) Keep the machine away from strong sunlight and high temperature in case plastic is distorted.

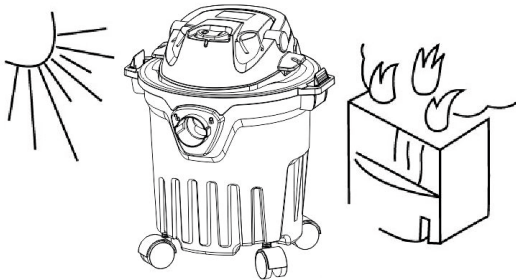

(9) Do not wrest, tramp, or haul hose in case of making it damaged.

(10) Do not immerse the barrel cap into the water or wash with water in case water goes into the electrophorus parts and causing person injury.

The correct way should be: immerse the dishcloth firstly, and then dry it. Finally, wipe the dirty part gently.

(11) The power cord must be replaced by the designated repairing center or

professionals.

4. Operation Method

(1) Connection

Insert the hose connector into the airinlet mouth, as shown in the picture; make sure the connector is tightly fastened.

Press the connector button as shown in the picture, and pull the connector out when you want to pull hose connector from machine.

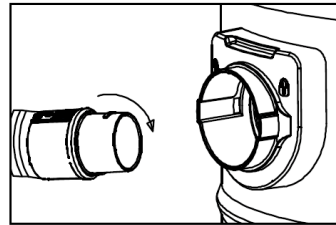
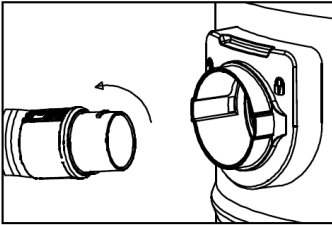

(2) Accessories

As shown in the picture, connect all the accessories for wet & dry cleaning.

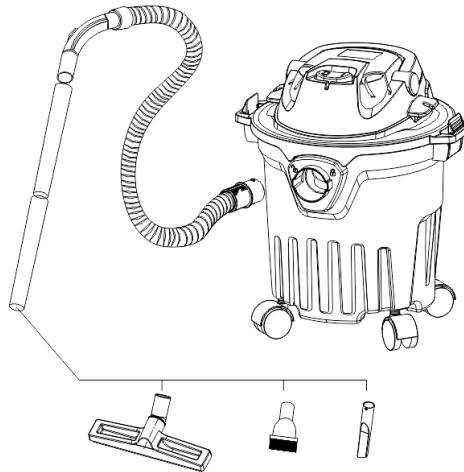

(3) Base

To make sure that the machine moves steadily, please make sure that the 4pcs bases with wheels are assembled tightly and rightly to the bottom.

Fit the screw on every piece of base directly to the hole on the bottom of the plastic tank, and press them!

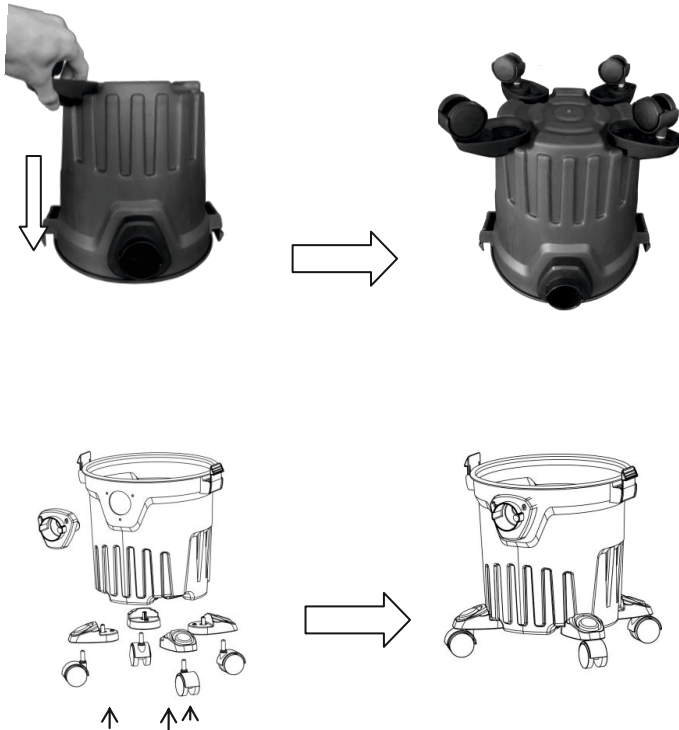

(4) Filters

For cleaning liquid: Please fit the sponge filter on the water volve (below the motor base)

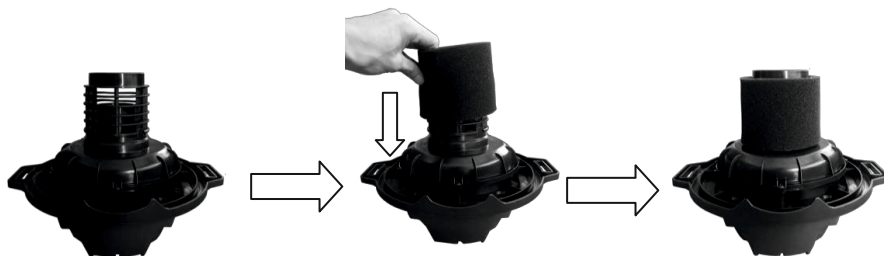

For cleaning dust: Please fit the HEPA filter on the water valve (below the motor base)

After fitting the right filter, please lock the head onto the plastic tank.

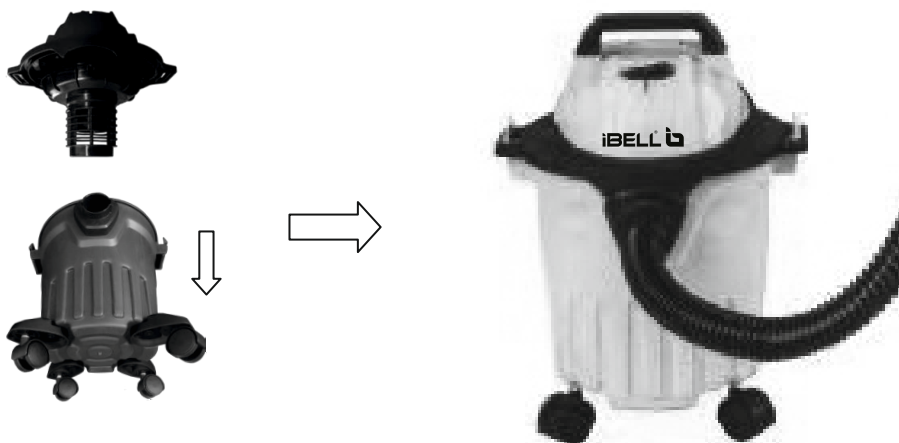

(5) Blowing function

Insert the hose connector into the blowing mouth as shown in the picture when you want to use the blower.

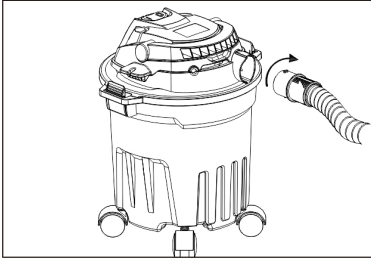

(6) Operation

1. Insert the plug into the powersocket.
2. Press the switch; the machine begins to work.
3. You can adjust the airflow by pushing the sliding block up and down.

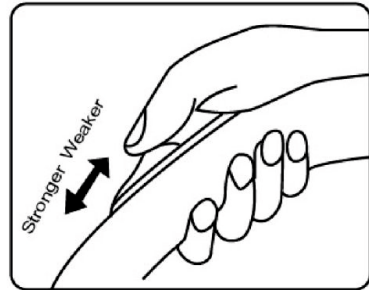
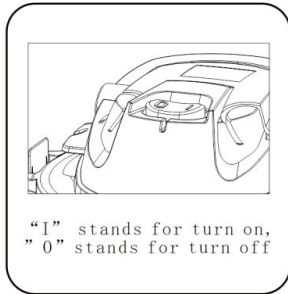

5. Protective device (Safety valve)



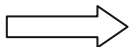

Special instruction concerning protective device.

(1) When the water in the barrel is full, the device begins to work.

The suction power will vanish at this moment. The machine will make some noise which indicates the motor is running at a high speed.

Under this circumstance, please cut off power, and clean up the water. Then equip the machine and turn it on. It will begin to work normally.

(2) When the machine is overturned, the device will begin to work. You should cut off the electricity and keep it upright, then turn on the machine.

(3) When the device is working, the motor will be damaged and burn if you use the machine. Under this circumstance, please stop using and clean up the water

6. Maintenance

(1) Barrel Cleaning

* After use or when the barrel is full of dust which causes decrease of suction considerably, please cut off the electricity and clean the dirt in the barrel.

- 1) Unfasten the locking knobs; lift up the top cover.
- 2) Take off the filters, clean the dirt in the barrel.
- 3) Install the filters again and place the top cover.

(2) Filter cleaning

* Filters should be washed by clean and warm water when it is covered with dirt. If necessary, you can use litmus scour.

- 1) Take off the filters
- 2) Wash

- 3) Dry
- 4) Fit the filters

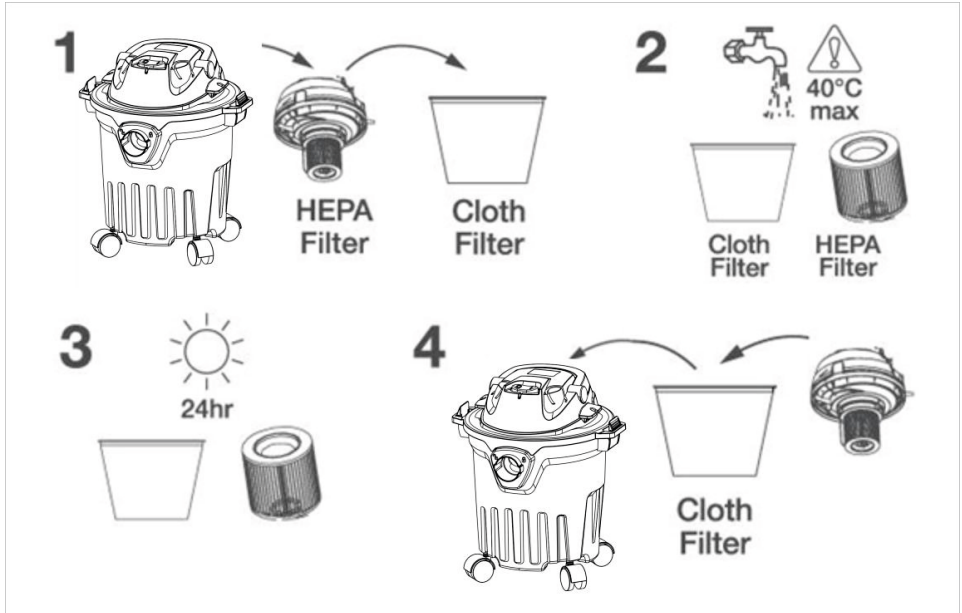

7. Tech-data

Model	Power	Voltage	Frequency
IBL VC 120YB	1200W	220V-240V	50/60Hz