

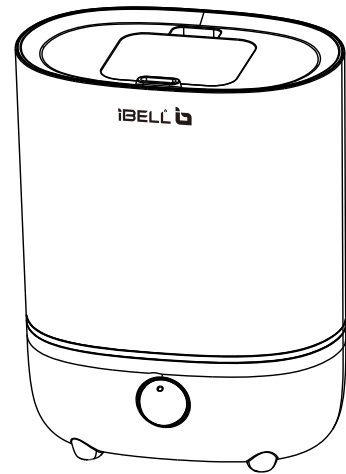

AIR HUMIDIFIER User Manual

IBL HU1003L



Thank you for purchasing our air humidifier, please read this instruction carefully before use, please keep this booklet for future reference.

※The pictures are for reference only

Product introduction

Ultrasonic technology is a relatively mature technology in the world, it is widely used in various fields, ultrasonic humidifier adopts ultrasonic high frequency oscillation principle, the water is atomized into 1-5 micron ultrafine particles, the water mist is diffused into the air through the pneumatic device, so as to achieve the purpose of uniform humidify the air, fresh air, moisten skin, improve health.

Product accessories list

Open the packing carton, please check the carton contains the following accessories



Product: 1pc



Manual: 1pc

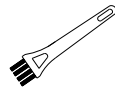

Brush: 1pc

Specification

Model	IBL HU1003L
Voltage	AC220V/50Hz
Wattage	25W
Noise Level	≤35dB (A)
Capacity	3.0L
Atomization time	Max mist:15H
Mist output	100-200mL/H
Net weight	
Gross weight	
Product size	208x146x275M
Packing size	248x173x315mm
Executive standard	GB4706. 1-2005 GB4706. 48-2009

Main Features

- Top filling, more convenient;
- Water shortage protection;
- LED water shortage indication;
- Spray for up to 15 hours;

Safety precautions

In order to ensure safe use, avoid causing you and others to receive injury and property loss, please observe the following safety precautions.

- ⚠ **Warning:** Indicates the possibility of serious accident or injury.;
- ⚠ **Attention:** Indicates possible product damage.;

The following conditions are not considered in this product:

- The use of appliances by unattended children and persons with disabilities;
- The product can not be play by children as a toy;
- This product is not suitable for people with physical or mental disabilities and lack of necessary experience and knowledge, unless used under the supervision of someone responsible for its security.

Warning



Forbidden to disassemble

Non-professional personnel, do not dismantle the machine, so as to avoid electric shock accident!

Do not place the product around a stove or other heat radiation source or inflammable or explosive materials to avoid accidents;

Please do not use wet hands to plug in or out the power to avoid electric shock.



Prohibition

When the machine is turned on, please do not touch the atomizer sheet and PTC heating film with hand to avoid hurting;

The power line must not be scratched, damaged, excessively bent, pulled, twisted, knotted, and do not press heavy objects on it or clamped or processed to avoid the risk of electric shock;

Please do not put metal products, chemicals, detergent into the water tank, otherwise there will be poor atomization problem.

This product is for indoor use only, keep out of reach of children.

Attention



Prohibition

Please confirm whether the voltage in this city conforms to the specification of the product before use.;

The product will produce moisture when working, please keep away from other household electrical appliances.

Do not place the product where it is exposed to strong light or hot air.;

When not in use for a long time, please cut off the power and unplug the power.

When pouring water into the tank, do not exceed the highest water level to prevent water overflow into the body.

Do not use hard object to knock the surface of the humidifier to prevent the shell from cracking.

Parts

Main engine explosion diagram

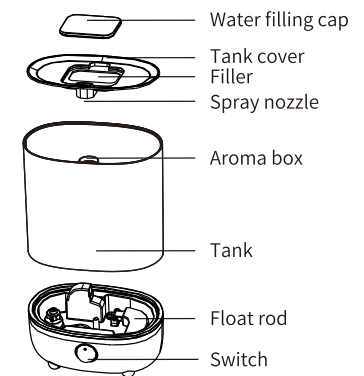

Back of product

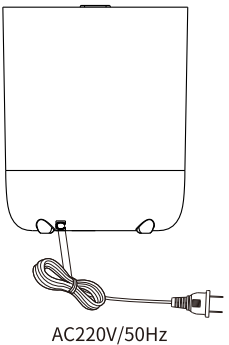

Panel function

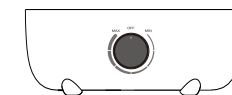

MAX	The maximum amount of mist
MIN	The minimum amount of mist
OFF	Switch/adjustment of mist
Blue LED light	operation mode
Red LED light	water shortage

Steps for usage

Steps for filling water

① The humidifier should be placed on a flat surface

② Open the cover and fill in water

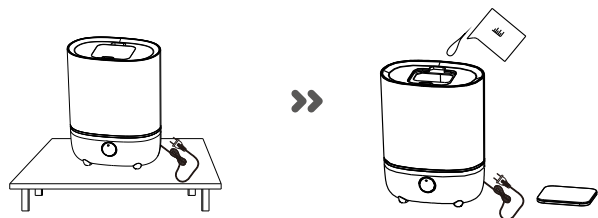

③ Note that water must not exceed the maximum water level.

□ Cover the tank cover and water filling cap, plug in the power cord

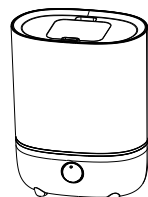
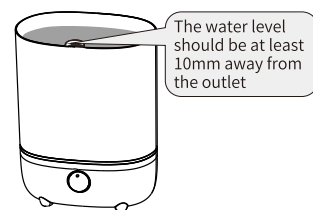

Attention

- Open the water tank cover and fill in water;
- Can be injected with clean tap water or pure water.;
- The water filling position should not exceed the maximum water level.

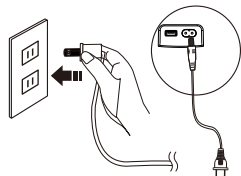

Steps of using

After the machine is plugged in, turn the fog switch clockwise, red indicator light will lighten, when the water is added to the water level switch, the blue light is on and the machine goes into spray mode, when spraying, the amount of mist can be adjusted by adjusting the switch.

Steps for usage

Steps of operation

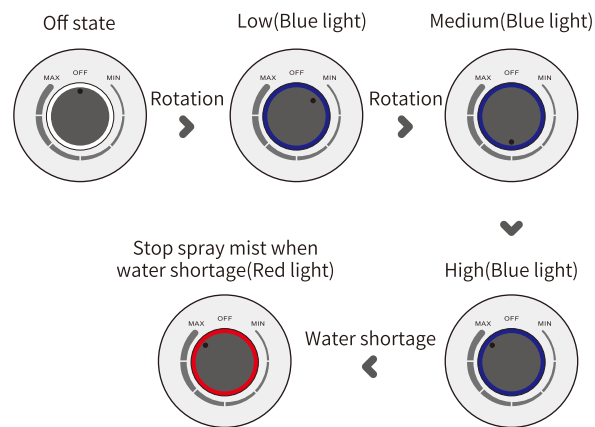

Stop spray mist when water shortage (Red light)

Add essential oils

Drip your favorite essential oil onto the aromatherapy cotton of this product, spray contains the smell of essential oils to improve the air better.

Drop two or three drops of essential oil

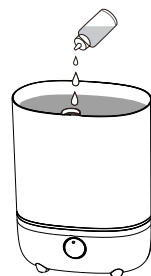

- Attention**
- Water-soluble essential oils must be used.
 - Do not drop essential oils directly into water.



Cleaning and maintenance

After appliance is used for a period of time, scale will appear, form "white powder" phenomenon; it is attached to the surface of the transducer, affecting the humidification effect. It is necessary to clean the main components of humidifier regularly.

Steps for usage

Cleaning and maintenance

- ① Add proper amount of water, clean the machine with cleaning brush.
- ② Wipe the atomizer with a cotton swab stuck with citric acid solution.



- Please do not use a sharp hard device to touch or concussion the atomizer sheet.
- Do not use detergent to clean, use clean water is better;

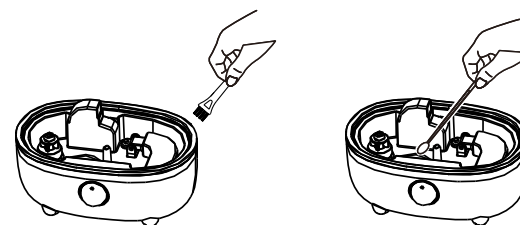

③ Rinse with water and wipe clean with a soft cloth

④ Add water and brush the tank with a brush

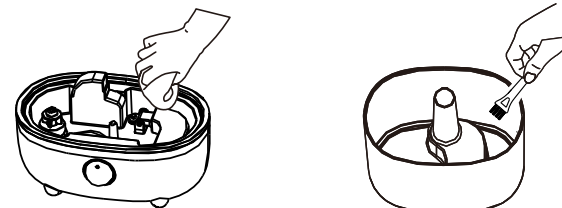

⑤ Rinse with water and wipe dry with a soft cloth

⑥ The shell can be wiped with a wet cloth, and then wipe dry with a clean cloth

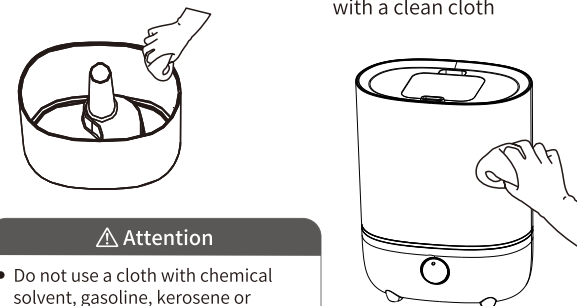

Attention

- Do not use a cloth with chemical solvent, gasoline, kerosene or polishing powder to wipe the surface;
- When cleaning, don't let water get into the inside body to avoid internal component being wet and malfunction;

Steps of using

Instruction of pouring water



Do not pour water from the direction of the outlet position

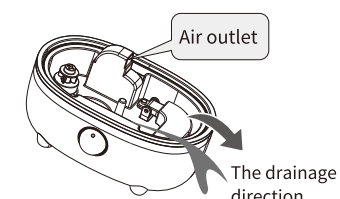

Troubleshooting

If your humidifier does not work properly, please check the following before requesting after-sales service.

Problem	Reason analysis	Troubleshooting method
Problem	The power is not plugged in properly	Plug in the power cord and turn on the power
There is water in the sink, but no or very little spray is left on	There is too much scale on the atomizer	Clean scale on atomizer
Atomization amount is too small	1. There is too much scale on the atomizer 2. The water is dirty or has been stored for too long time 3. The atomization amount is set at the minimum gear	1. Clean scale 2. Change to clean water 3. Set it to the corresponding gear
Abnormal noise	1. There's too little water in the sink 2. It collides with the table surface to produce jitter	1. Adding water 2. Place on a firm, smooth surface
The mist overflowed from the bottom of the tank	The tank is not in place or there is debris in the water	Reinstall the tank
Peculiar smell of mist	The water in the sink is not clean or has been sitting for too long	Clean the sink and replace it with clean water